

AUTOCAD DRAFTSMAN OR SOLIDWORKS DESIGNER FAST TRACK CERTIFICATE

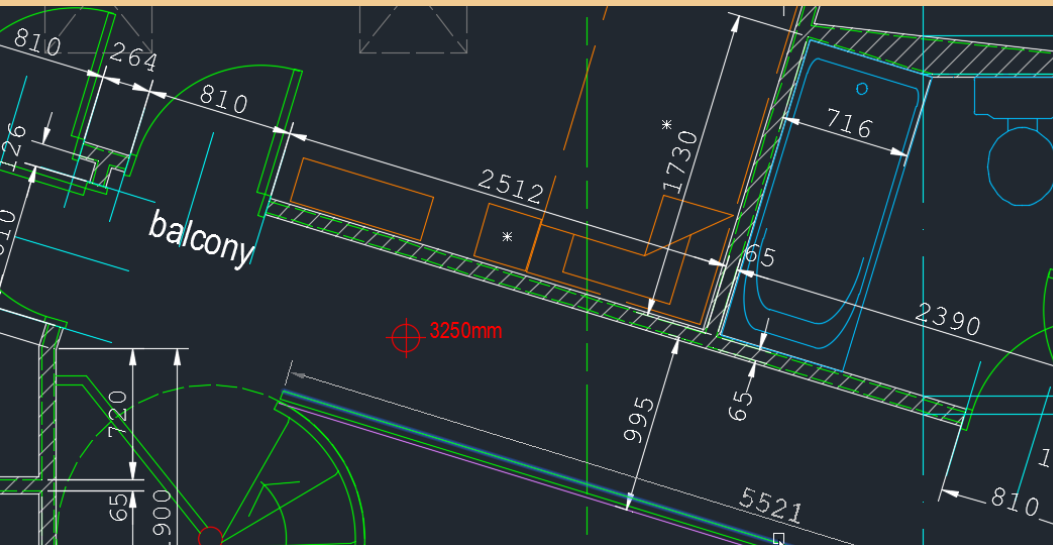

A Program Overview of the Energy, Manufacturing & Construction Area of Study

Updated as of May 2019



Programs At-A-Glance

AutoCAD Draftsman Fast Track Certificate

Available at LSC-CyFair, LSC-Kingwood, LSC-Montgomery, LSC-North Harris and LSC-University Park

LoneStar.edu/AutoCAD-Draftsman-Certification

Entry Wage: \$39,537

SolidWorks Designer Fast-Track Certificate

Available at LSC-CyFair, LSC-North Harris and LSC-University Park

LoneStar.edu/Solid-Model-Design

Entry Wage: \$36,947

*Texas Wages and Employment Projections is brought to you by the Labor Market & Career Information (LMCI) Department of the Texas Workforce Commission. www.TexasWages.com, 2017.

Lone Star College does not discriminate on the basis of race, color, gender, religion, disability, age, veteran status, sexual orientation, nationality, or ethnicity in its programs and activities. For more information, see <http://LoneStar.edu/legal-notices.htm>. For Occupational Licensing please review the latest information: LoneStar.edu/ConsequencesCriminalConviction.

This certification will prepare you for entry-level employment opportunities in drafting and design. The AutoCAD Draftsman certificate involves hands-on training with AutoDesk, one of the most popular computerized drafting applications used in manufacturing and construction.

AutoCAD Architecture permits architectural designers to draw 3D objects, such as walls, doors and windows, with more intelligent data associated with them rather than simple objects, such as lines and circles. The data can be programmed to represent specific architectural products sold in the construction industry, or extracted into a data file for pricing, materials estimation, and other values related to the objects represented.

Additional tools generate standard 2D drawings, such as elevations and sections, from a 3D architectural model. Similarly, Civil Design, Civil Design 3D, and Civil Design Professional support data-specific objects, facilitating easy standard civil engineering calculations and representations.

FOR MORE INFORMATION:

Please contact the Continuing Education Department at LSCCE@LoneStar.edu for more information.

LoneStar.edu/AutoCAD-Draftsman-Certification

AUTOCAD DRAFTSMAN OR SOLIDWORKS DESIGNER FAST TRACK CERTIFICATE



AutoCAD Draftsman Fast-Track Certificate

96 Contact Hours

AutoCAD: Introduction

AutoCAD: Intermediate

AutoCAD: Advanced

SolidWorks Designer Fast-Track Certificate

60 Contact Hours

SolidWorks I

SolidWorks II

Corporate College

Professional development opportunities are available for additional training and licensure.

Representative career titles and job positions for the programs plan include:

**AutoCAD Draftsman
Fast-Track Certificate**
• CAD/CAM Specialist²

¹Entry Wage: \$39,537

**SolidWorks Designer
Fast-Track Certificate**
• Civil Structural Designer²

¹Entry Wage: \$37,169

¹Texas Wages and Employment Projections is brought to you by the Labor Market & Career Information (LMCI) Department of the Texas Workforce Commission. www.TexasWages.com, 2017

²Position titles vary by employer and location.

**Complete your AutoCAD
Draftsman or SolidWorks
Designer Fast Track Certificate
in 15 Weeks!**

For more information on gainful employment, visit LoneStar.edu/GainfulEmployment.

